

Datasheet **Window Handle Air** Part No: 100177



About the product

The wireless Window Handle Air quickly and reliably detects open, closed or tilted windows and can be easily integrated into a Loxone system.

In addition, an in-built vibration sensor detects if force is used to gain entry, and sends an immediate notification via the app, email or audible alarm.

- Detects open, closed or tilted windows
- Detects glass breakage by vibration
- Modern design with stainless steel finish
- Installed in under 5 minutes
- Battery-powered (batteries have up to 2 year's lifetime)
- For greater security and peace of mind

Technical data

Power supply	2x 1.5V AA batteries
Battery lifetime	up to 2 years
Interfaces	Loxone Air: 868MHz (SRD Band Europe), 4 channels available 915MHz (ISM Band Region 2), 10 channels available max. Power 3.16mW
Ambient temperature	0 ... 50°C / 32 ... 122°F
Humidity	max. 95% r.H. (non condensing)
Humidity Detection Range	0 ... 100% r. H. +/- 2%, (non condensing)
Spindle to screw ratio	
Spindle length	32/37mm, 43mm
Screw length	40 & 50mm, 50 & 60mm
Square spindle	7mm

Connection diagram

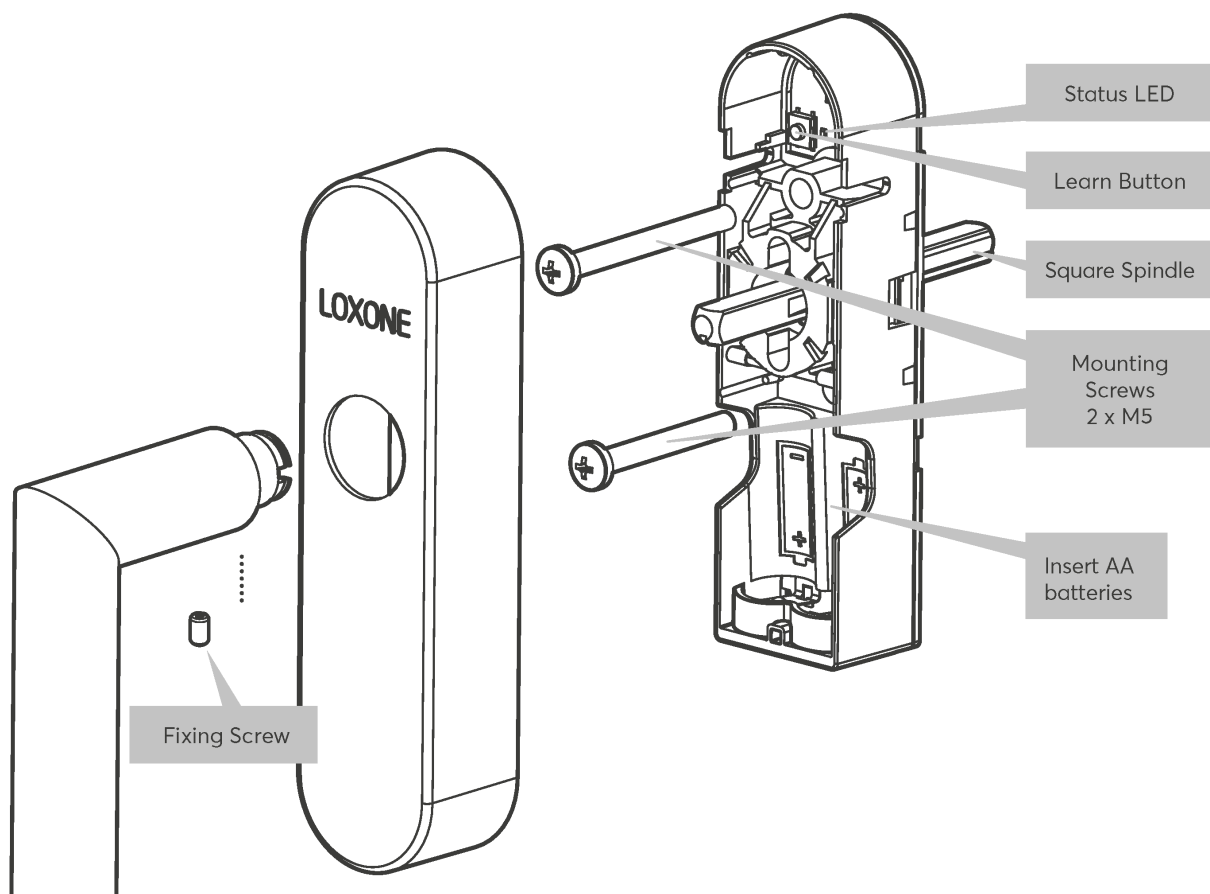

Product features

Locking	4x 90° ball locking
Material	stainless steel
Finish	matte

Weight & dimensions

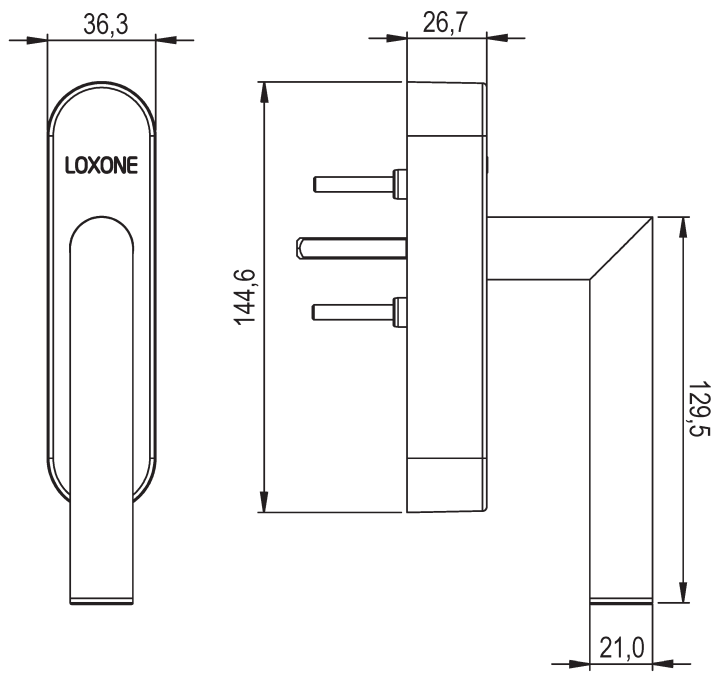
Net weight	218g
Total weight	360g
Product dimensions	144.6x36.3x26.7mm / 5.69x1.43x1.05" (LxWxH)
	 <p>The technical drawing shows two views of the Loxone device. The front view on the left shows a vertical rectangular device with a rounded top and a central slot. The width is dimensioned as 36,3 mm. The side view on the right shows the device's profile, including three ball-locking pins on the left side. The total height is dimensioned as 144,6 mm, the width of the main body is 26,7 mm, and the height of the bottom section is 129,5 mm. The bottom width is dimensioned as 21,0 mm. The brand name 'LOXONE' is visible on the front view.</p>
Pack size	230x160x38mm / 9.06x6.30x1.50" (LxWxH)

Certifications & Standards

Safety rating	IP20
----------------------	------

Installation must be carried out by a qualified electrician in accordance with the relevant regulations.
Published by

Loxone Electronics GmbH

Smart Home 1

4154 Kollerschlag

Austria

Phone: +43 7287 7070-0

loxone.com